

Map a Network Drive to a MAC OS

Updated by AP, December 2023

Connect to an LU Network Drives/Share

This method maps a network drive that may disappear if the network connection drops or if you reboot your Mac.

1. Ensure that you are connected to Ivanti Pulse VPN.
For more information, refer to: [Ivanti Pulse VPN Guide](#)

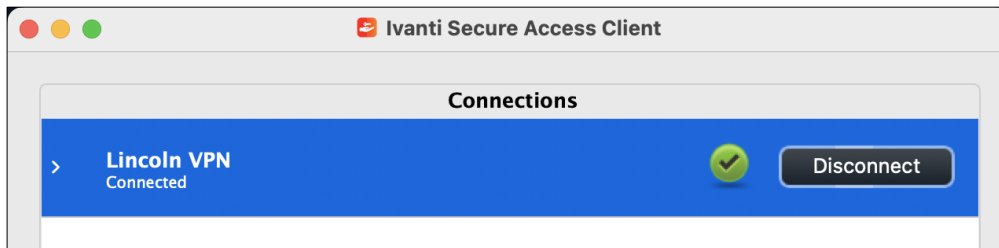

2. Make sure you are on Finder:

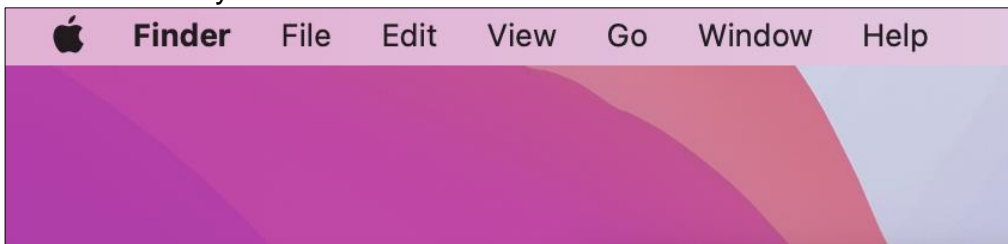

3. Press Command and K, then type the UNC path and click connect.
For LUshare, type in: **smb://c-fs4/LUShare**

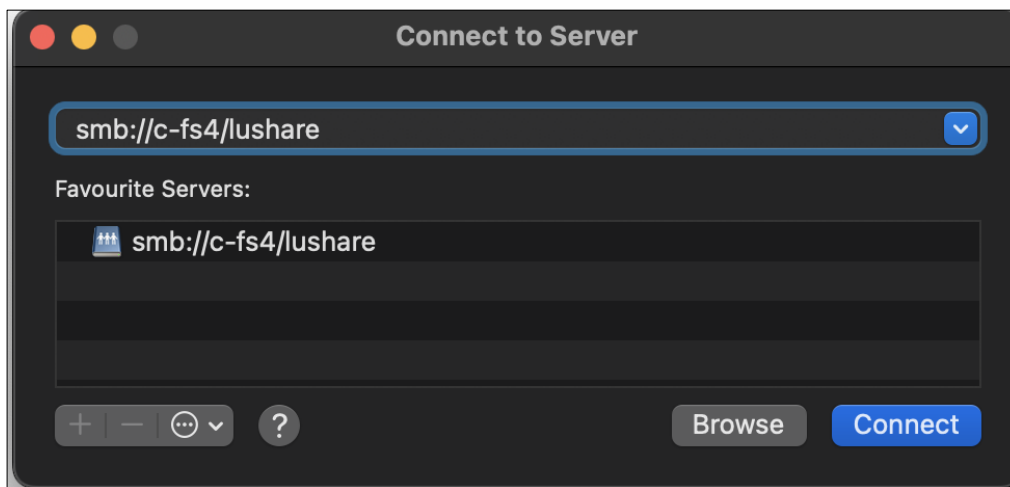

4. On the next Window, click on 'Registered User'
 - Type your LU username and password (remember to include 'lu' before your username) **lu\username**

- Click on 'Connect'.

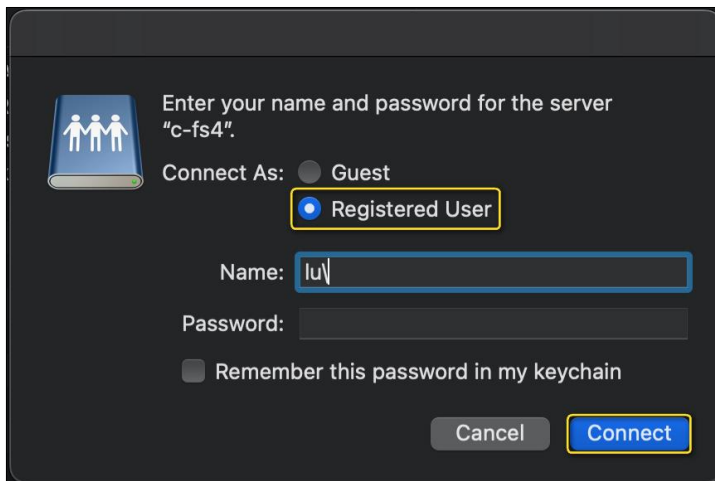

The drive will now appear on your desktop and in the Finder window sidebar.

You can only access the network drive or computer if you have access or permission to do so.

Another way to connect:

- a) Right click on Finder.
- b) Click on 'Connect to Server'.
- c) Follow the previous step 3.

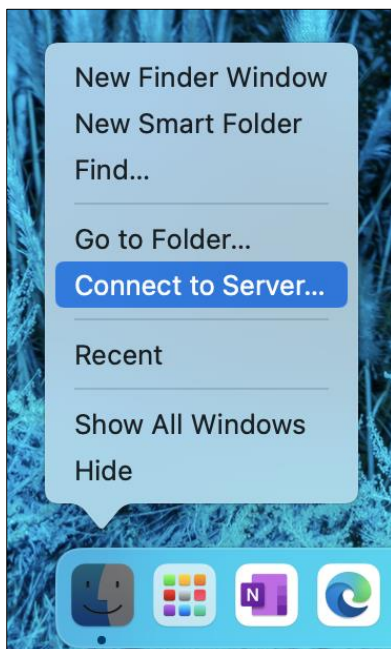

Map a network drive to Mac OS X that re-mounts after system reboot

This method allows you to reboot your Mac and have the mapped network drive automatically remount and appear on the desktop. To ensure persistence after a system reboot:

- Navigate to System Preferences from the Apple menu.
- Click on Users & Groups.
- Select your user account and click on Login Items.
- Click on the + button to add another login item.
- Locate the network drive you previously mounted and click Add.
- Exit out of System Preferences.

Your network drive will now be mapped and automatically remounted when you reboot your Mac.

Make the mapped network drive visible on the Mac desktop

It's possible that the mounted drive will not appear on the desktop due to a system setting. If you want the mapped drive icon to be visible on the Desktop, be sure to do the following additional steps:

- From the Finder, open Finder Preferences by hitting Command and ,
- Click the General tab
- Select the checkbox next to 'Connected Servers'
- Close Finder Preferences

Selecting the checkbox next to Connected Servers ensures that you'll see the icon on your Mac Desktop, otherwise it will only be visible in the Finder window sidebars and Open/Save dialogues.

Remount mapped network drive with a click

A great additional step for either method is to create an alias of the mapped network drive. This allows you to reconnect to the share with just a click. Here's how to do this:

- Right-click on the mapped network drive on the Mac OS desktop
- Select "Make Alias"

Now you can double-click that alias to reconnect to the network drive instantly.